



## *Live the good life in the contemporary design of **The Oasis***

### **Oasis**

1,104 sq. ft.  
2 Bedrooms  
2 Bathrooms

### **Options:**

- R-31 Floor
- R-22 Exterior Walls
- R-50 Roof includes 2" Polyurethane Spray Foam
- Upgrade Vinyl Siding w/ Concrete Stone Accents
- Custom Windows c/w Grey Outside Trim & White Inside Trim
- Custom Exterior Doors c/w Grey Outside Trim & White Inside Trim
- 5 Panel Rockport Interior Doors c/w Upgrade Hardware
- Convectair Allegro II Heaters throughout c/w Programmer
- In-floor Heating in Ensuite Bathroom
- HRV with Booster Switches in Kitchen, ¾ Bath & Ensuite
- Exterior & Interior LED Pot Light on Dimmer Switches
- Custom Built Frameless Cabinetry
- Custom Built Closet Organizer in Master Bedroom
- Custom Built Dining Room Bench c/w Heated Seat
- Hanstone Quartz Countertop in Kitchen and Ensuite c/w 4" Backsplash
- Stainless Steel Appliances
- Undermount Kitchen Sink & Upgrade Faucet
- Ensuite Bath c/w Undermount Sink, Soaker Tub & Upgrade Faucets, Ceramic
- Tile Flooring & Tub Surround
- ¾ Bath c/w Vessel Sink, Shower Base with Shower Doors, Upgrade Faucets,
- Ceramic Tile Shower Surround, Cushion Flooring
- Upgrade Laminate Flooring throughout Main Living Space & Bedrooms
- All Chrome Finishes
- Upgrade Lighting Package
- 8'-0" Ceilings sloped to 9'-10 ¼"



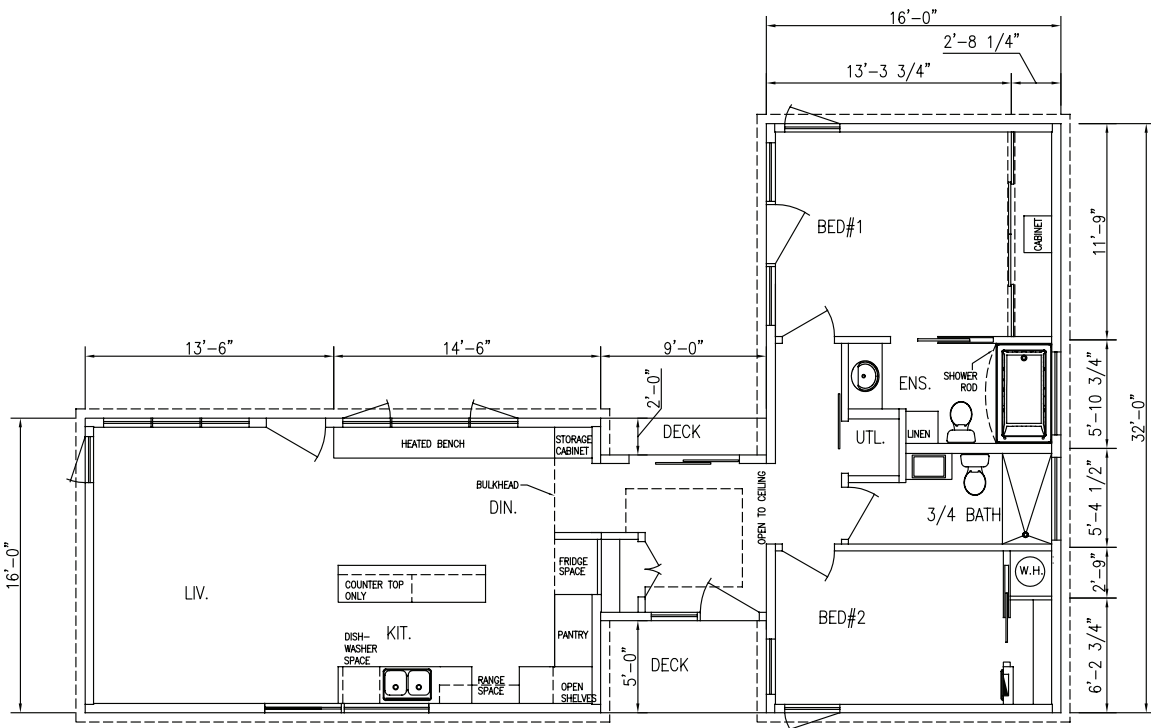

## We build **your** home, **your** way.

Customization at its best, you have the option of choosing from our large selection of some of the best home designs in the industry. From traditional Mini-Homes to our newest Countryview design, the quality care and service of the Maple Leaf Team will exceed your expectations. Once you have chosen your design, our design consultant will assist you in customizing your new home to suit your personal style and taste. Anything from siding colour to kitchen cabinets will be tailored just for you! Start envisioning your dream home today! For more information on this or any other Maple Leaf Home, visit our website at [mapleleafhomes.ca](http://mapleleafhomes.ca) for a retailer in your area.

## MAPLE LEAF HOMES

655 Wilsey Rd., Fredericton NB, Canada E3B 7K3

Tel: 506-459-1335 • [www.mapleleafhomes.ca](http://www.mapleleafhomes.ca)